

LXW26 Series Universal Rotary Switch

Operation method	Character code	Position of handle																
		30° rotation				45° rotation				60° rotation				90° rotation				
Self-return	A																	
	B				0°													
Limited movement	C				30°													
	D				0°	30°												
	E				30°	0°	30°											
	F				60°	30°	0°	30°	60°									
	G				60°	30°	0°	30°	60°	90°								
	H				90°	60°	30°	0°	30°	60°	90°							
	I				90°	60°	30°	0°	30°	60°	90°	120°						
	J				120°	90°	60°	30°	0°	30°	60°	90°	120°	150°				
	K				120°	90°	60°	30°	0°	30°	60°	90°	120°	150°				
	L				150°	120°	90°	60°	30°	0°	30°	60°	90°	120°	150°			
	M				150°	120°	90°	60°	30°	0°	30°	60°	90°	120°	150°	180°		
	N																	
	Limited movement and self-return	Z				30°	0°	60°										
						60°	30°	0°	30°	60°								

Specification and size

Description	Escutcheon plate	Dimensions(mm)				Installation(mm)			
		A	B	C	L	A	b	d1	d2
LXW26-10	M0 square	30	30	28	26.5+12n			ø8	ø3.2
LXW26-20	M1 square	48	48	43	22+9.6n	36	36	ø8.5	ø4.5
	M2 rectangle	48	60	43	22+9.6n	36	36	ø8.5	ø4.5
	M2 square	64	64	43	25+9.6n	48	48	ø10	ø4.5
	M1 rectangle	64	80	43	25+9.6n	48	48	ø10	ø4.5
LXW26-25	M1 square	48	48	45.2	23+12.8n	36	36	ø8.5	ø4.5
	M1 rectangle	48	60	45.2	23+12.8n	36	36	ø8.5	ø4.5
	M2 square	64	64	45.2	26.5+12.8n	48	48	ø10	ø4.5
	M2 rectangle	64	80	45.2	26.5+12.8n	48	48	ø10	ø4.5
LXW26-32	M2 square	64	64	58	29.2+12.8n	48	48	ø10	ø4.5
	M2 rectangle	64	80	58	29.2+12.8n	48	48	ø10	ø4.5
LXW26-63	M2 square	64	64	66	29.2+21.5n	48	48	ø10	ø4.5
	M2 rectangle	64	80	66	29.2+21.5n	48	48	ø10	ø4.5
	M3 square	88	88	66	29.2+21.5n	68	68	ø10	ø4.5
LXW26-125	M3 square	88	88	84	35+26.5n	68	68	ø13	ø6
	M3 rectangle	88	107	84	35+26.5n	68	68	ø13	ø6
	M3 square	88	88	88	35+32.5n	68	68	ø13	ø6
LXW26-160	M3 rectangle	88	107	88	35+32.5n	68	68	ø13	ø6

Note: n means number of layers

Escutcheon plate

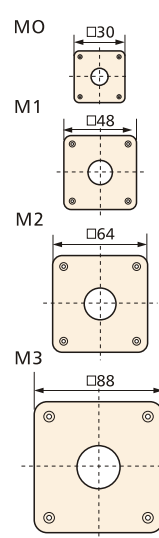

Type of handle

Type of handle	Color	Escutche on plate			Type of handle	Color	Escutche on plate		
		M1	m2	m3			M1	m2	m3
MO	Black				MO	Black			
	Red					Red			
	White					White			
M1	Black				M1	Black			
	Red					Red			
	White					White			
M2	Black				M2	Black			
	Red					Red			
	White					White			
M3	Black				M3	Black			
	Red					Red			
	White					White			

Note: standard color, optional color

1-5 (thickness of the installing plate)

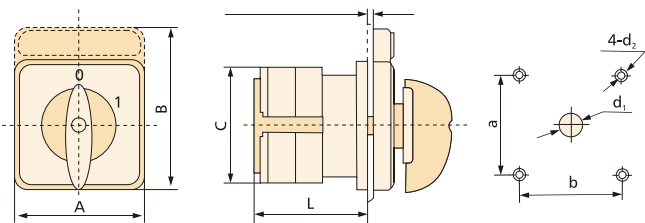

LXW26-10 installation (mm)

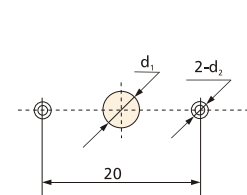

Model & Specification	Escutcheon plate	Type of handle										Rotating angle	Maximum number of layers		
		M0	M1	M1	M2	R	F	I	B	S	L			P	K
LXW26-10	●														
LXW26-20	●●														
LXW26-25	●●														
LXW26-32	●●														
LXW26-63	●●														
LXW26-125	●●														
LXW26-160	●●														

LXW26-20 installation (mm)

